

TACOFLOW2
TACOFLOW2 ADAPT
TACOFLOW2 ELINK
TACOFLOW2 SOLAR
TACOFLOW2 PURE





Tsirkulatsioonipumpade paigalduse, hoolduse ja remondi peab teostama selleks volitatud personal ning kasutada on võib vaid originaalvaruosi ja -tarvikuid. Tacoflow2, Tacoflow2 Adapt, Tacoflow2 Elink, Tacoflow2 Solar, Tacoflow2 Pure C kasutamine muul otstarbel, kui juhistes märgitud, on keelatud ja seda peetakse sobimatuks, välja arvatud juhul, kui selleks on eelnev kirjalik kokkulepe ettevõttega Taco Italia Ltd. TÄHELEPANU: kui pakend ja/või tsirkulatsioonipump on nähtavalt kahjustatud, ei tohi tsirkulatsioonipumpa mitte mingil juhul kasutada.

EEI – ENERGIAEFEKTIIVSUSE INDEKS

TACOFLOW2 60
TACOFLOW2 ADAPT 60 EEI ≤0,20 - Part 2
TACOFLOW2 SOLAR 60

TACOFLOW2 C 60
TACOFLOW2 C 70
TACOFLOW2 70 EEI ≤0,21 - Part 2
TACOFLOW2 ADAPT 70
TACOFLOW2 SOLAR 70

TACOFLOW2 C A 60 EEI ≤0,23 - Part 2

Kõige tõhusamate ringluspumpade energiatõhususe indeks: EEI ≤0,20



KUUM TARBEVESI

TACOFLOW2 PURE C

Tacoflow2 Pure C pumba komponentide kokkupuudet joogiveega on testitud ja see on kooskõlas joogivee direktiiviga 98/83/EÜ. Ringluspumba paigalduse, hoolduse ja tavapärase töö ajal ei tohi need komponendid puutuda kokku ainetega, nagu lisaained, määrded, õlid, silikoonid jms, mis võiksid põhjustada vee saastamise riske ja selle tagajärjel seada ohtu inimese tervisele. Taoliste ainete igasugune tahtlik kasutus peab olema alati ja igal juhul Taco Italia poolt heaks kiidetud.

Enne paigaldust tuleb ringluspumpa hoida pakendis kuivas keskkonnas.

TACOFLOW2 - TACOFLOW2 CA



MAX

0.6 MPa (6 bar)

MIN

0.03 MPa (0.3 bar)

@50°C

0.10 MPa (1.0 bar)

@95°C



Glycol max 30%



Max. 95% RH
IP44



< 43 dB(A)



Min. +2°C / +36°F
 Max. +95°C / +203°F



Min. +0°C / +32°F
 Max. +40°C / +104°F

MIN [°C]

MAX [°C]

[°C]

2

95

0

10

95

10

20

95

20

30

95

30

35

90

35

40

70

40

TACOFLOW2 ADAPT - TACOFLOW2 SOLAR - TACOFLOW2 ELINK



MAX

1.0 MPa (10 bar)

MIN

0.03 MPa (0.3 bar)

@50°C

0.10 MPa (1.0 bar)

@95°C

0.15 MPa (1.5 bar)

@110°C



Glycol max 30%



Max. 95% RH
IP44



< 43 dB(A)



Min. +2°C / +36°F
 Max. +110°C / +230°F



Min. +0°C / +32°F
 Max. +40°C / +104°F

MIN [°C]

MAX [°C]

[°C]

2

110

0

10

110

10

20

110

20

30

110

30

35

90

35

40

70

40

TACOFLOW2 PURE C

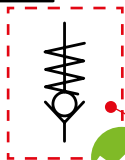

MAX

1.0 MPa (10 bar)

MIN

0.03 MPa (0.3 bar)

@50°C

0.10 MPa (1.0 bar)

@95°C



Max 38°d



Max. 95% RH
IP44



< 43 dB(A)





Min. +2°C / +36°F
Max. +95°C / +203°F



Min. +0°C / +32°F
Max. +40°C / +104°F

MIN [°C]

MAX [°C]

[°C]

2	95
10	95
20	95
30	95
35	90
40	70

0
10
20
30
35
40

Paigaldada ainult süsteemidele, mis on varustatud paisupaagi ja tagasilöögiklapiga.

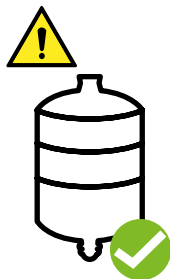

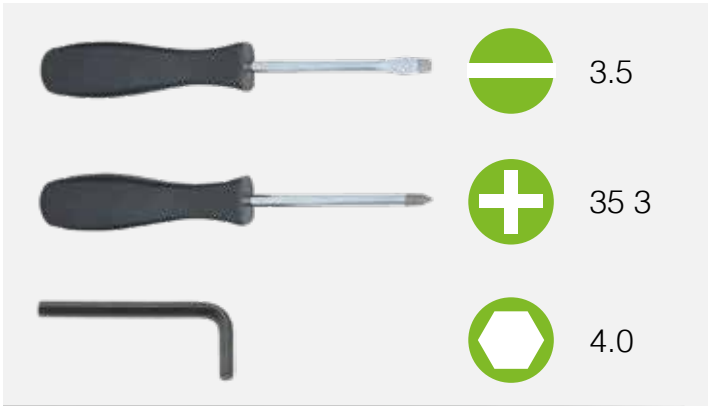

TACOFLOW2 ADAPT





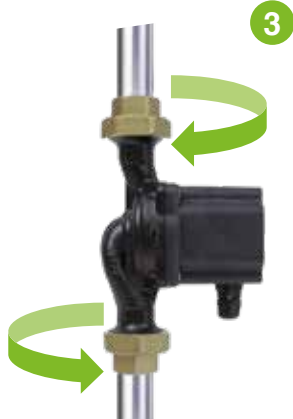
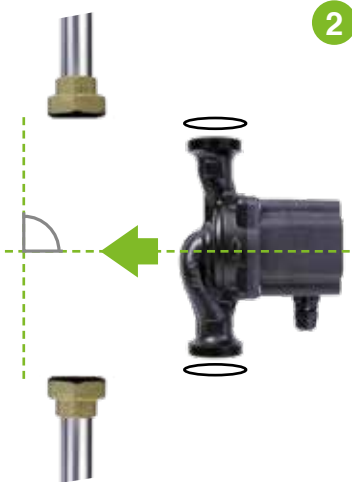
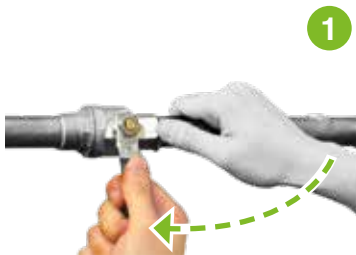

G1	PA 66 GF	Max. 50 Nm
G1	EN-GJL-200	Max. 85 Nm
G1½	EN-GJL-200	Max. 125 Nm
G2	EN-GJL-200	Max. 165 Nm

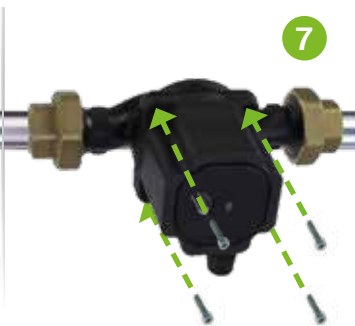
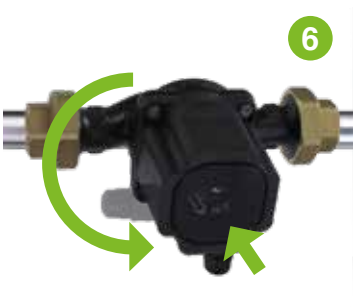
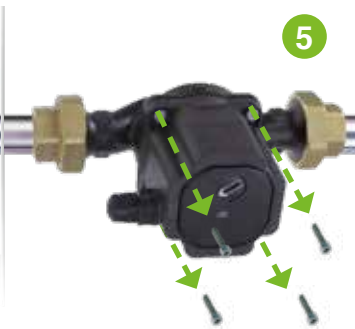

$3,3 \pm 0,5 \text{ Nm}$



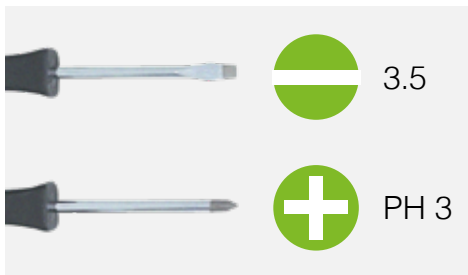

A

min. Ø 5 mm
max. Ø 10 mm

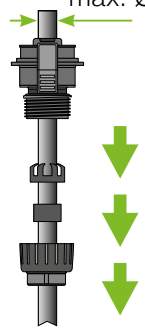

B

5 mm
12 mm

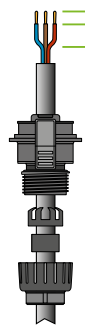

C

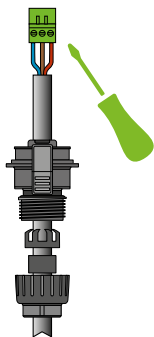

D

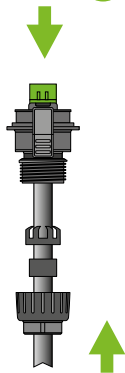

E

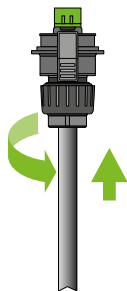

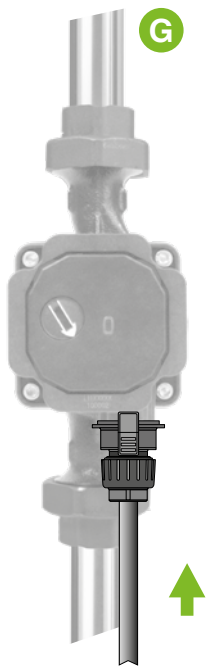
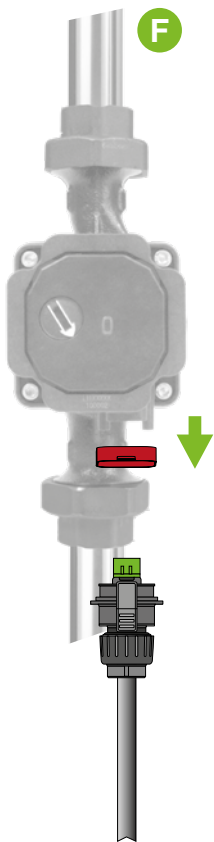



H



1x230 V ($\pm 10\%$), 50 Hz

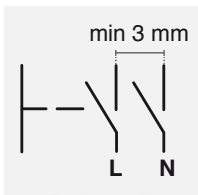

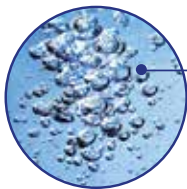

Täiendav
dokumentatsioon



www.Taconova.com

1a



1b

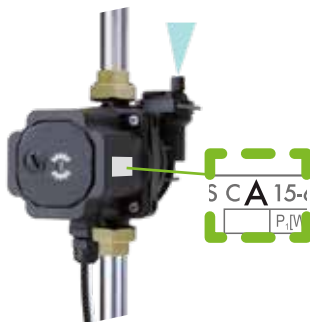

2



3



TACOFLOW2 ELINK

Laadige alla ja paigaldage
rakendus eLink+ Taco Control



Taco Control





Täiendav
dokumentatsioon



www.Taconova.com

PUNANE LED-TULI

HOIATUS!

Tsirkulatsioonipump on blokeeritud, kuid toide on olemas. Vt altpoolt tõrkeotsingu jaotist

VASTAVUSDEKLARATSIOON

Taco Italia S.r.l. deklareerib oma ainuvastutusel, et tootepere TACOFLOW, mille kohta see deklaratsioon on välja antud, vastab nõukogu direktiivile ELi liikmesriikide õigusaktide ühtlustamise kohta, mis puudutavad:

EMCD Directive (2014/30/EU)

Standard used: EN 61000-3-2:2014, EN 61000-3-3:2013, EN 55014-1:2006, EN 55014-2:2015 (amendments included)

LVD Directive (2014/35/EU)

Standard used: EN 62233:2008, EN 60335-1:2012, EN 60335-2-51:2003 (including amendments)

Ecodesign Directive (2009/125/EC and 2012/27/EU)

Commission Regulation n. 641/2009 and n. 622/2012.

Applies only to circulators marked with the energy efficiency index EEI. See the pump nameplate.

Standards used: EN 16297-1:2012 and EN 16297-2:2012

RoHS II Directive (2011/65/EU)

Sandrigo, 31/05/2018

Luca Bolcati

General Manager & Managing Director









Taco Italia S.r.l.

Via Galileo Galilei, 89/91 - Sandrigo (VI) - Italy

Person authorized to compile technical file and empowered to sign the EC declaration of Conformity.

This EC declaration of conformity is only valid when published and distributed as part of the Taco installation and operating instructions.

KIRJELDUS	DESCRIPTION		LED
ActiveADAPT režiim	ActiveADAPT mode	TACOFLOW2 ADAPT	 active ADAPT
Režiim P ($\Delta p-v$) - Proportsionaalne rõhkude erinevus	P mode ($\Delta p-v$) - Proportional differential pressure		 P
Režiim C ($\Delta p-c$) - Püsiv rõhkude erinevus	C mode ($\Delta p-c$) - Constant differential pressure		 C
Režiim min-max - fikseeritud kiirus	min – max - Fixed speed		 min - max
Õhk pumbas. Eemaldage õhk	Air detected. Proceed with the vent routine		 air
Anomaalia: Rotor blokeeritud, madal toitepinge, elektriline viga	Fault: Rotor blocked, Insufficient supply, Electrical fault		



taconova

comfort solutions

Taconova jätab endale õiguse teha toodetes muudatusi sellest eelnevalt teatamata.

Taconova Group AG

Neunbrunnenstrasse 40 | CH-8050 Zürich

T +41 44 735 55 55 | F +41 44 735 55 02

info@taconova.com

TACO ITALIA S.r.L.

Via Galileo Galilei, 89/91 | IT-36066 Sandrigo (VI)T

+39 0444 666800 | F +39 0444 666801

info@tacoitalia.com | tacoitalia.com

Maaletooja:



Cerbo

küttesüsteemid • müük • paigaldus • hooldus

tel 442 0222 / 434 1000 • www.cerbo.ee • info@cerbo.ee



taconova.com

