

LK 924 / 925 SafetyGroup

- Many connection options
- Several pressure classes possible
- Compact

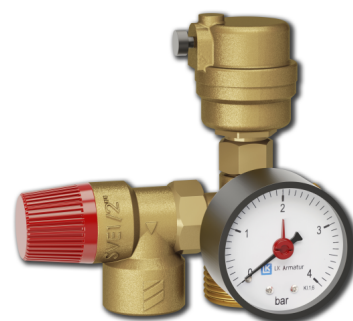

Technical Data

Working temperature:	Min 5 °C/Max 110 °C
Ambient temperature:	Min 5 °C/Max 60 °C
Max. working pressure:	See the table below
Thread standard:	Rp - female thread, G - male thread
Material, valve body:	Brass EN 12165 CW617N

LK 924 / 925 SafetyGroup is a safety group for heating systems. The safety group contains manifold, manometer, safety valve and an air vent. 924 SafetyGroup has an automatic air vent with a float and 925 SafetyGroup has an automatic air vent with fibre discs. The manifold has two ½" connections for safety valve and for example an expansion vessel, one ¾" connection for air vent.

The manometer shall be mounted in one of the three ¼" connections, plug the other ¼" connections with supplied plugs. Depending on model the manifold has a female ¾" connection or a male 1" connection towards the heating system.

The manometer, air vent with a float and one ½" connection on the manifold are provided with a PTFE seal. Safety valves in other pressure classes can be supplied upon request.

LK 924 - Female Thread

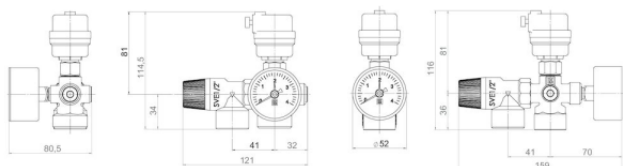

Article	Dim.	Opening pressure	Weight (kg)
092309	F ¾"	0,3 MPa	0.6



LK 924 - Male thread

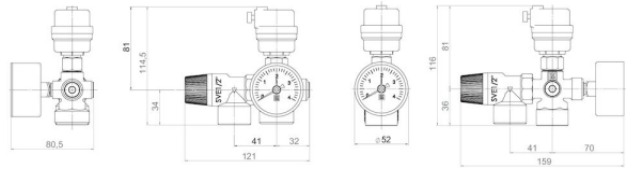
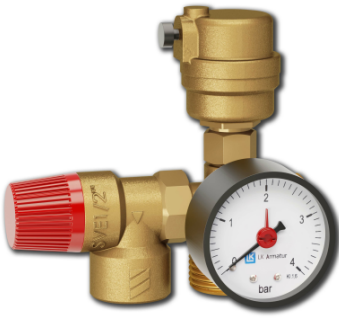

Article	Dim.	Opening pressure	Weight (kg)
092310	M 1"	0,3 MPa	0.6

LK 925 - Female thread

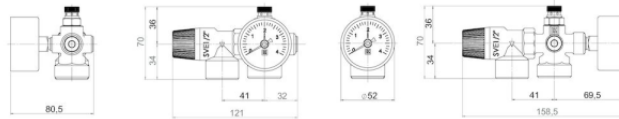
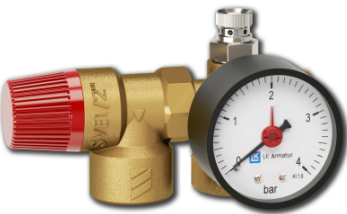

Article	Dim.	Opening pressure	Weight (kg)
092307	F 3/4"	0,3 MPa	0.5

LK 925 - Male thread

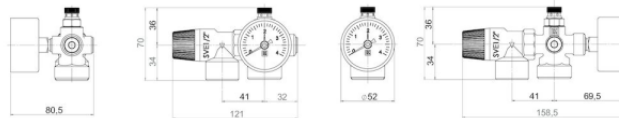
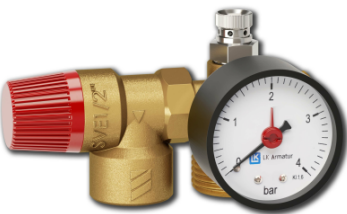

Article	Dim.	Opening pressure	Weight (kg)
092308	M 1"	0,3 MPa	0.5



Accessories & Spare parts

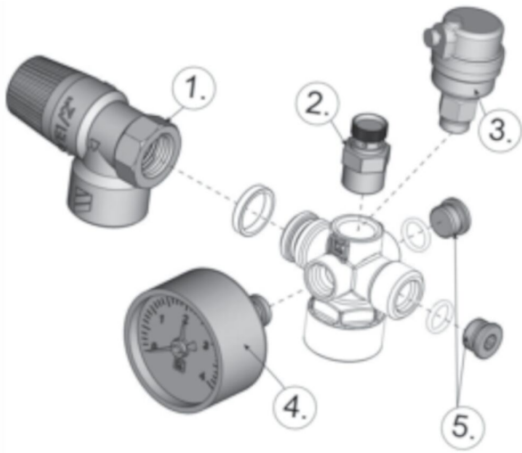

Article no.	Article	Position
095491	Safety relief valve 0.3 MPa	1
095492	750 G10 Ventilating valve	2
095497	740-G10 Floating air vent	3
095279	Manometer 50-4 bar M ¼"	4
095493	Plug ¼"	5