

Wi-Fi Roller Shutter



**EROL-WIFI**

**Quick Guide**

Ver. 1.0  
Release date: IX 2024  
Soft:  
Main module v2.1.17  
MCU: v1.2.2

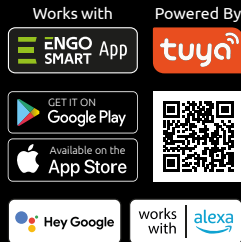

Producer:  
Engo Controls Sp z o.o. Sp. k.  
43-262 Kobilice  
Rolna 4 St.  
Poland

[www.engocontrols.com](http://www.engocontrols.com)

**Technical specifications**

Power supply	230V AC 50Hz
Max load	2x16(5)A
Communication	Wi-Fi 2,4GHz
Output SL1, SL2	230V AC 50 Hz
Input S1, S2	230V AC 50 Hz
Dimension [mm]	46 x 46 x 24

**Introduction**

The roller shutter controller allows to control rollers via wall switch and Engo Smart mobile app. With 16A relays, the controller can cope with large motor drives. Installation in the wall box behind the wall switch is simple and aesthetically pleasing. Device allows you to check the position of the roller shutter, set timers and schedules and integrates with Amazon Alexa or Google Assistant. Thanks to Wi-Fi communication, this device can operate as a standalone unit without an Internet gateway.

**Product features**

- Powerfull relays: 2x16A
- Can be controlled via roller shutter buttons or from the app
- Works with ENGO Smart (compatible with Tuya App)
- Mounting in a flush-mounted box or on a DIN rail - bracket included
- Support for voice commands via Amazon Alexa or Google Assistant.

**Product Compliance**

This product complies with the following EU Directives: 2014/53/EU i 2011/65/EU.

**Safety Information:**

Use in accordance with national and EU regulations. Use the device only as intended, keeping it in a dry condition. The product is for indoor use only. Installation must be carried out by a qualified person in accordance with national and EU regulations.

**Installation:**

Installation must be performed by a qualified person with appropriate electrical qualifications, in accordance with the standards and regulations in force in a given country and in the EU. The manufacturer is not responsible for non-compliance with the instructions.

**ATTENTION:**

For the entire installation, there may be additional protection requirements, which the installer is responsible for.

**Input/Output**

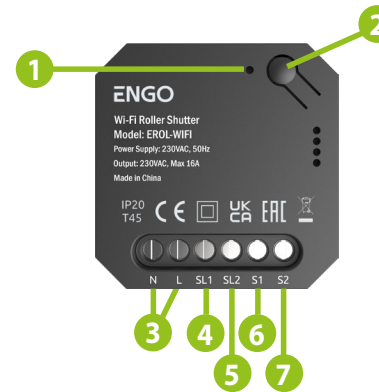

1. LED diode
2. Function button
3. Power supply 230V AC
4. SL1 - 230V AC output for opening
5. SL2 - 230V AC output for closing
6. S1 - 230V AC signal input for opening
7. S2 - 230V AC signal input for closing

**LED diode indications**

	EXPLANATION
<b>LED diode flashes on blue</b> ●●●●●...	The device is in pairing mode with the application (when the device does not has been previously added to the app, or after restoring factory settings)
<b>LED diode lights up blue</b> ●	The device is connected to a Wi-Fi network

**Button functions**

	EXPLANATION
click 5 times, the LED will flash blue ●●●●●...	Module reset (device will be removed from the application and automatically will go into pairing mode). In addition, device beeps when in pairing mode.

**Connection description**

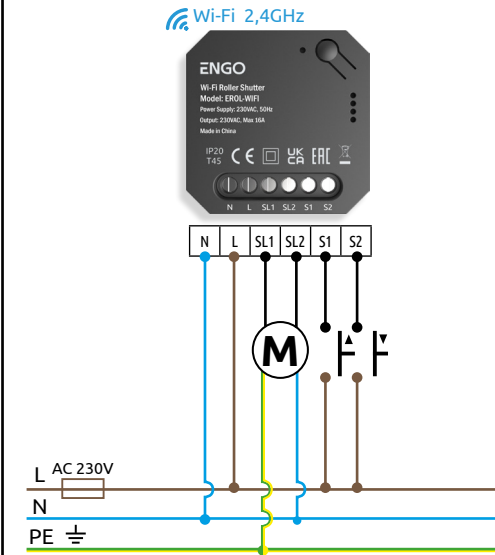

**Legend:**

- Fuse
- L, N 230V AC power supply
- PE Ground (electricity)
- SL1, SL2 Roller shutter drive control (output) contacts - 230V AC
- S1, S2 Roller shutter drive control (input) contacts - 230V AC
- Roller shutter drive
- Monostable contact (momentary)
- Wireless communication

## Installation thermostat in the app

Make sure your router is within range of your smartphone. Make sure you are connected to the Internet. This will reduce the pairing time of the device.

### STEP 1 - DOWNLOAD ENGO SMART APP

Download the ENGO Smart app from Google Play or Apple App Store and install it on your smartphone.



Powered By



### STEP 2 - REGISTER THE NEW ACCOUNT

To register a new account, please follow the steps below:

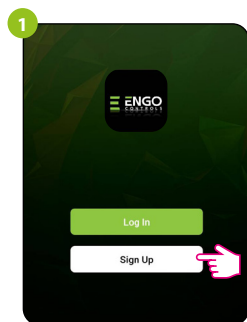

Click „Register“ to create new account.

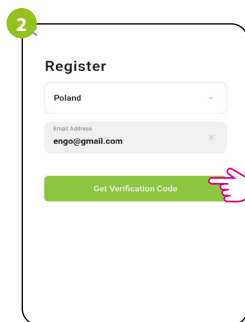

Enter your e-mail address to which the verification code will be sent.

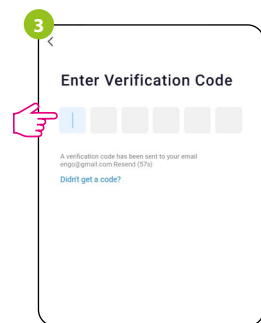

Enter the verification code received in the email. Remember that you only have 60 seconds to enter the code!!

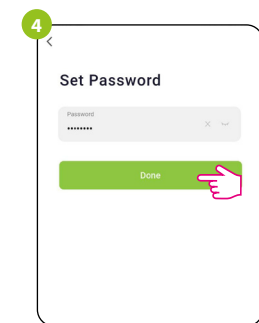

Then set the login password.

### STEP 3 - CONNECT THE RELAY TO WIFI

After installing the app and creating an account:

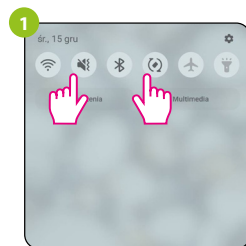

On your mobile device, make sure the ENGO Smart has access to permissions (Location, Bluetooth, Nearby devices). Then turn on Bluetooth and Location. Connect to 2.4GHz Wi-Fi network to which you want to assign the device.

Make sure the roller shutter is connected to the power supply. Blue LED should flash quickly. If not, press the button 5 times quickly or switch the controller's power off/on 5 times. The relay will enter pairing mode. In addition, device beeps when in pairing mode.

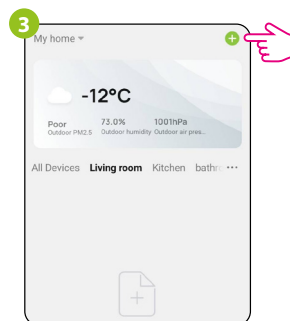

In the app, select „Add Device“.

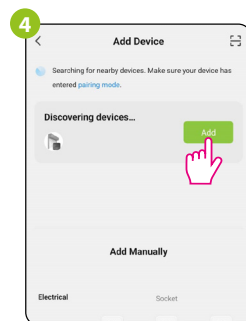

After finding the device, go „Add“.

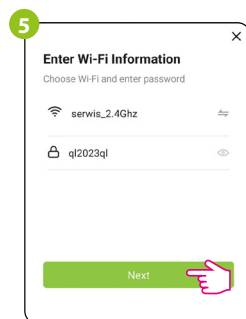

Select the Wi-Fi network in which the device will operate and enter the password of this network.

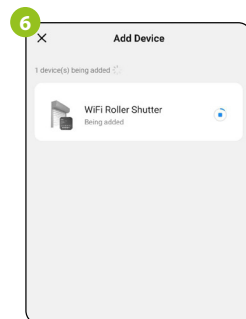

Wait for the app to configure the module with the selected Wi-Fi network.

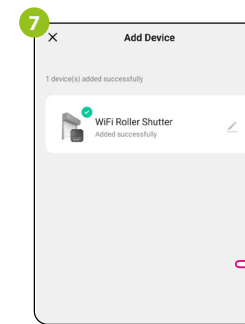

Go „DONE“.

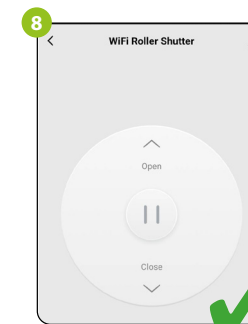

The roller shutter has been installed and displays the main interface.

### Device calibration

It is important to calibrate opening time of the roller shutter - so the opening/closing percentage levels will be displayed accurately in the app and will refer to the actual state of the roller shutter.

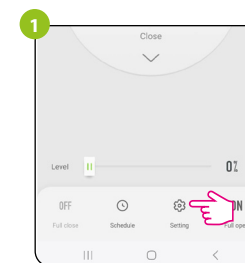

Go „Settings“.

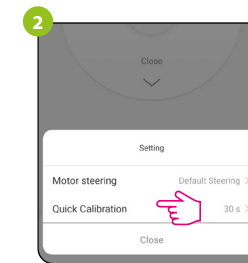

Select: „Quick Calibration“.

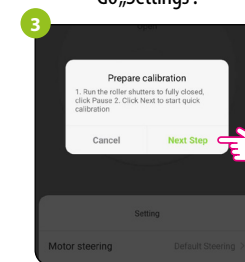

Click „Next step“.

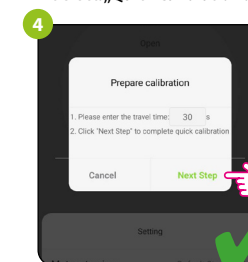

Enter the opening time of the roller shutter and confirm.

### Factory reset

To reset the device, press the button 5 times quickly or switch the controller's power off/on 5 times. The LED will start flashing blue. The roller shutter will be removed from the application, then goes into pairing mode. Now it's possible to add the relay again (see STEP 3 - CONNECT THE RELAY TO WIFI). Device will return to the previous network if it is not added to the new one.

